

935 RODA

FRAMELESS DOOR



ROLAIRE

ROLH-935

Rolaire Parts List

ITEM NO.	PART NUMBER	DESCRIPTION	QTY.
1	SC893	1" HEADER, TUBE	1
2	SC938	U-CHANNEL (HORIZONTAL)	1
3	SC938	U-CHANNEL (VERTICAL)	1
4	SC892	FILLER	1
5	SCV920	3/8" VINYL, DRIP	1
6	SCV353	3/8" VINYL, SEAL	2
7	SC4700	WALL MOUNT HEADER BRACKET	2
8	SC4640	CLAMP WITH ANTI-JUMPER	1
9	SC4800-01	ROLLER ASSEMBLY WITH STOPPER PIN	1
10	SC4800-02	ROLLER ASSEMBLY	1
11	SC4610	GUIDE	1
12	SC4710	BOTTOM CATCH	1
13	SC4910 or SC4950	18" PULL/KNOB or BACK TO BACK KNOB	1
14	--	1/8" BUMPER	3
15	--	1/4" BUMPER	3
-	SCCELESTA-4PP	PARTS PAK	1
16	SC4106	PLASTIC WALL PLUG	20
17	--	ALCOHOL PAD	2
18	SCR09SV	#8 X 1 1/2 STRIKE JAMB SCREW	20
19	SCV924	1/16 SETTING BLOCK	10
20	SCV925	1/8 SETTING BLOCK	10

NOTE: Not every part in parts pak will be used

** Part not shown.

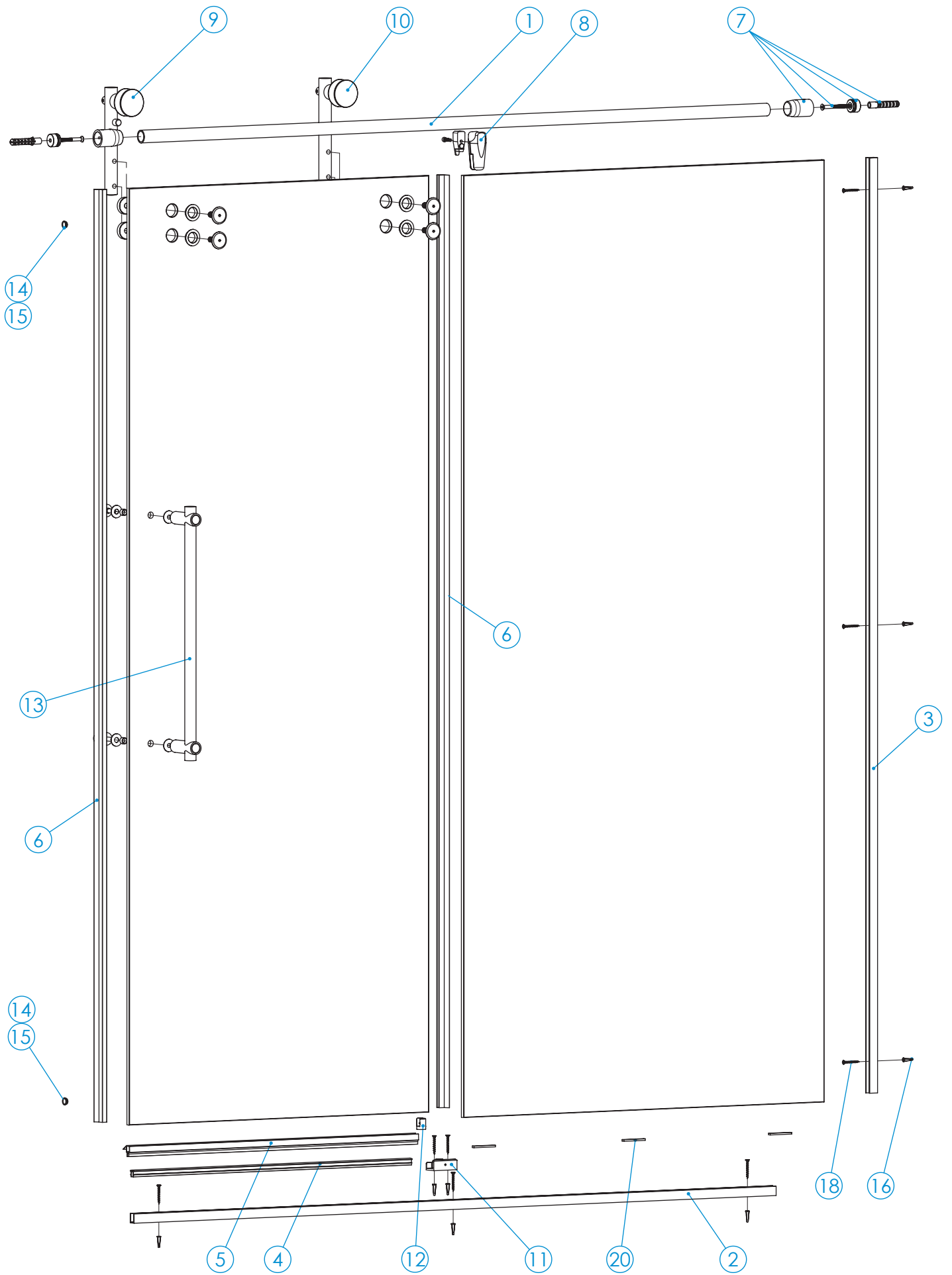

Tools:

To install your Basco Shower Enclosure, you will need the following:

- Pencil
- Low Tack Masking Tape
- Tape Measure
- 4 ft & 6 ft Level
- #2 Phillips Screwdriver
- Drill
- 3/16", 1/4", 7/16" Drill Bits
- Hack Saw
- Caulking (Clear Silicone Recommended)
- Caulking Gun
- Suction Cups
- Center Punch (if drilling into tile)
- Files

Installation Notes:

This unit is best installed by two people.

Cover the drain with tape prior to installation to prevent the loss of small parts.

Unpack your unit carefully and inspect for freight damage. Lay out and identify all parts using the instruction sheets as a reference. Before discarding the carton, check to see that no small hardware parts have fallen to the bottom of the box. If any parts are damaged or missing, refer to the description noted in the instructions when contacting your dealer for replacements.

Handle the glass panels carefully and protect the edges. Safety tempered glass is very resistant to breakage, but the sharp corners of the panels can damage tile and flooring surfaces. The glass can break if unequal pressure is applied during installation.

Wear safety glasses whenever drilling or cutting. When drilling holes in ceramic tile or marble, use a center punch and hammer to carefully break the glazed surface, to prevent skidding when drilling.

Maintenance:

Three primary materials are used to manufacture your new Basco shower enclosure: tempered glass, anodized aluminum and stainless steel. To assure a long lasting finish on the enclosure, wipe it down with a towel after each use.

For occasional, more concentrated cleaning efforts, we find that **Lysol Non-Abrasive Bathroom Cleaner** works extremely well. Be sure that any over spray falling on the metal frame is rinsed thoroughly and dried. Many over-the-counter cleaners, if applied to the metal and left on, will harm the finish and cause permanent damage, even though their directions indicate safe use on shower doors. Never use a scouring agent to clean the metal. For more care and cleaning information as well as instructions for units with Aquaglide XP glass protection, please visit our website www.BascoShowerDoor.com

NOTE: Tempered glass cannot be cut.

1 If a continuous unit centerline does not exist from the original measuring process, it will be necessary to create one. Lightly mark a continuous unit centerline on the threshold. Next, mark a continuous unit centerline on each wall, starting where the threshold centerline meets the wall. Use a level to ensure the wall centerline is plumb and straight. The wall centerlines should be a minimum of the unit height from the threshold.

Note: Centerline (CL) is a term used to describe the center or mid-point of the unit. The position of the unit centerline can be located anywhere within the width of the threshold, as long as adequate structure exists beneath the centerline for fastening and the outer edges of the unit will not overhang the threshold. The most common unit centerline position is the middle of the threshold.

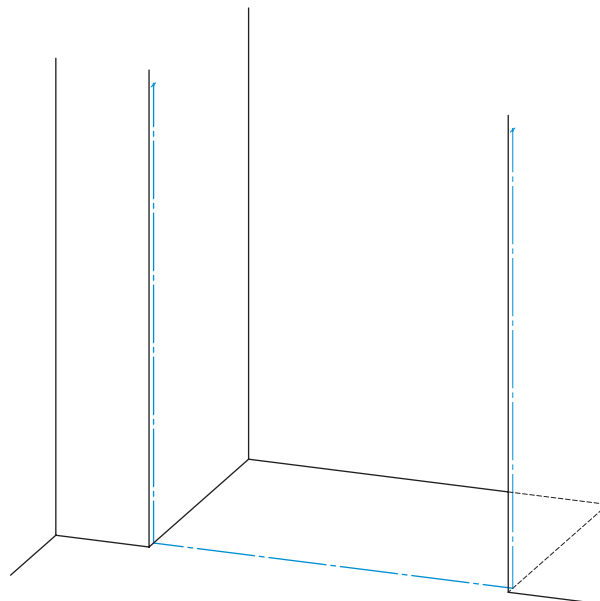

Note: It is extremely important the unit centerline is continuous and straight to ensure proper installation.

2 Use a level to check the threshold for out of level conditions if the original measured conditions are not available. If no conditions exist, measure up each wall centerline a distance of $Unit\ Height - 1/2"$ from the threshold, and clearly mark each location.

Note: $Header\ Mount\ Hole = Unit\ Height - 1/2"$, or $Panel\ Glass\ Height + 1\ 11/16"$

If out of level conditions exist; measure up the "high" side wall centerline a distance of " $Unit\ Height - 1/2"$ from the threshold and clearly mark this location. For the wall centerline distance on the "low" side of the threshold, use a level to determine the threshold out of level distance and add that value to the equation " $Unit\ Height - 1/2"$. Measure this summed distance up the "low" side wall centerline, from the threshold and clearly mark this location. Next drill a $7/16"$ diameter hole approximately 3" deep, at each marked wall location. (See illustration example.)

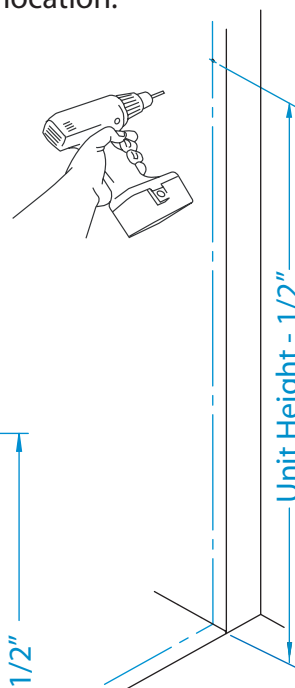

****IMPORTANT****

Keep both holes in-line to ensure the header mounts level.

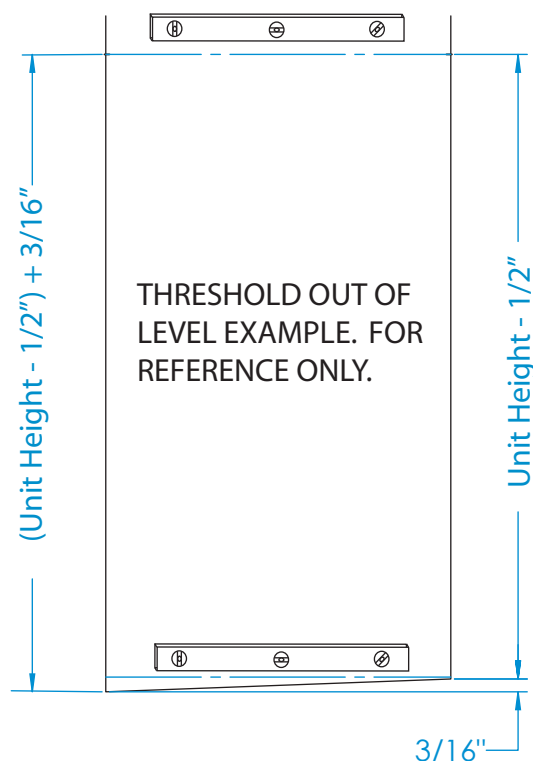

3 Verify that the U-channel is cut [2] to the appropriate size. This piece of U-channel will be equal to the opening width.

Next drill three 3/16" diameter holes in the center of U-channel [2] (centerline groove provided for convenience), two holes approximately 2-1/2" from each end and one in the middle. Place the U-channel in its correct position with the u-channel centerline over the threshold centerline as marked in step one. With a pencil carefully mark each hole position on the threshold centerline. Remove the u-channel and drill a 3/16" diameter hole, approximately 1" deep, directly on the threshold centerline at the marked locations.

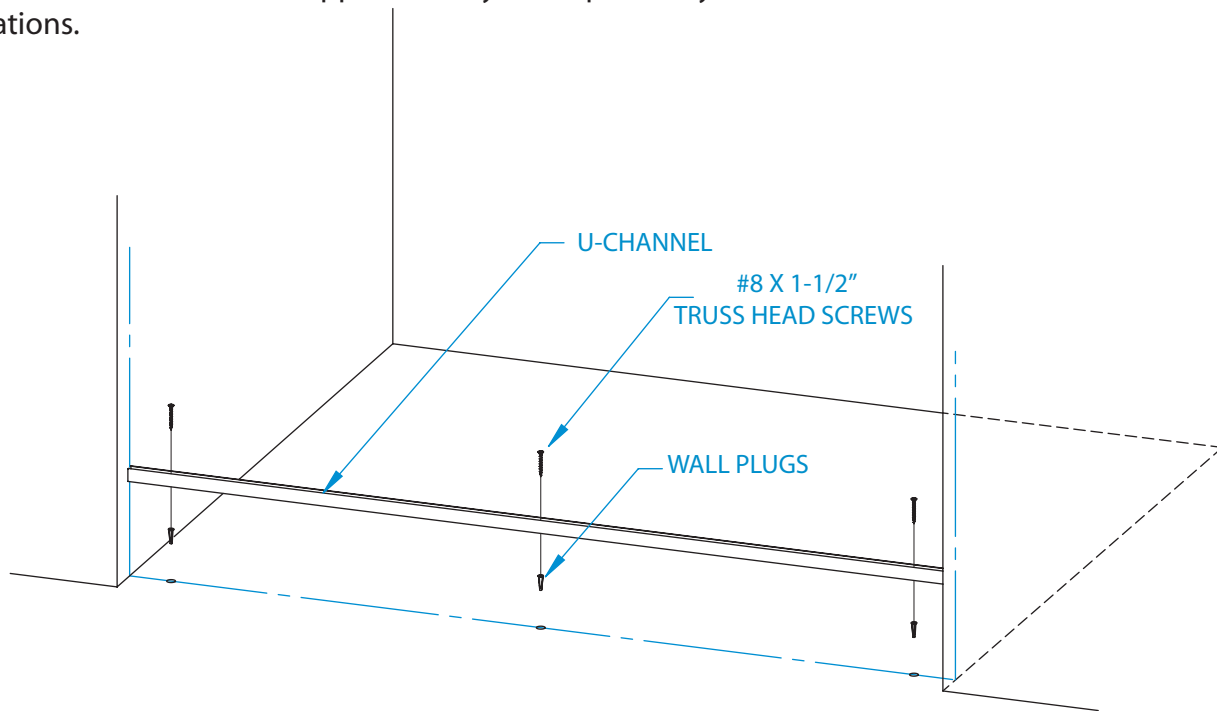

4 Insert a small amount of silicone into each drilled hole and insert a wall plug [16] into each hole. This must be done just before the U-channel installation. Then carefully cut heads off the wall plugs with a razor blade so there is nothing raised above the surface of the threshold. Place the U-channel in correct position and secure it with #8 x 1-1/2" truss head screws [18].

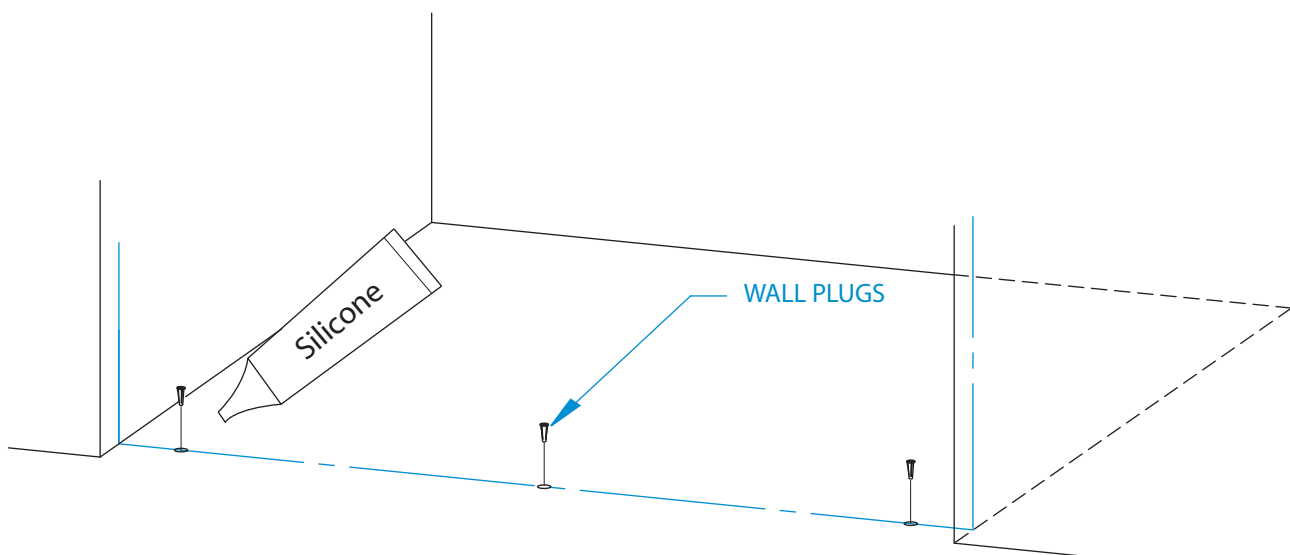

Note: Do not overtighten screws

5 Verify that the U-channel [3] is cut properly using the below formulas:

$$U\text{-channel Height} = \text{Unit Height} - 2\ 3/4''$$

or

$$U\text{-channel Height} = \text{Panel Glass Height} - 9/16''$$

Note: If out of level conditions exist be sure to use the longer U-channel on the appropriate side (see illustration).

Next, drill three 3/16" diameter holes in the center of U-channel (centerline groove provided for convenience); one hole 2-1/2" from each end and one hole in the middle. Place the U-channel over the wall centerline marked in step one. With a pencil, carefully mark each hole position on the wall centerline. Drill a 3/16" diameter hole, approximately 1" deep, directly on the wall centerline at the marked locations.

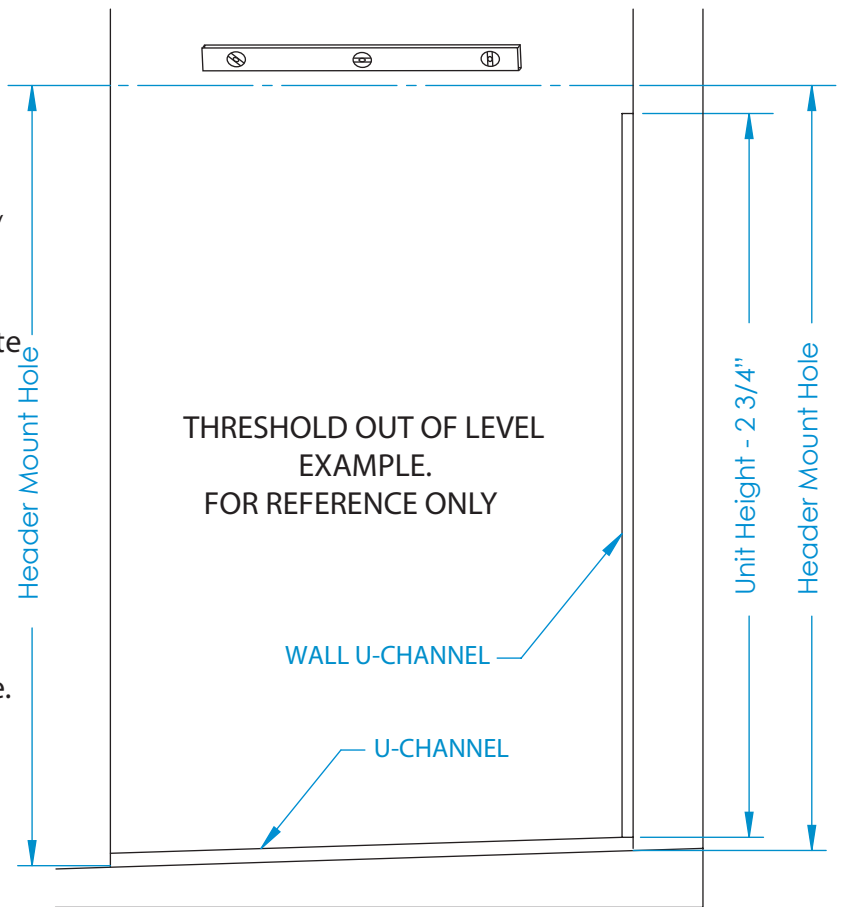

6 Insert a wall plug [16] into each drilled hole. Then carefully cut the heads off of the wall plugs [16] with a razor blade. So there is nothing raised above the surface of the wall. Place the u-channel [3] in position and secure it with #8 x 1-1/2" truss head screws [18].

Note: Do not overtighten the screws.

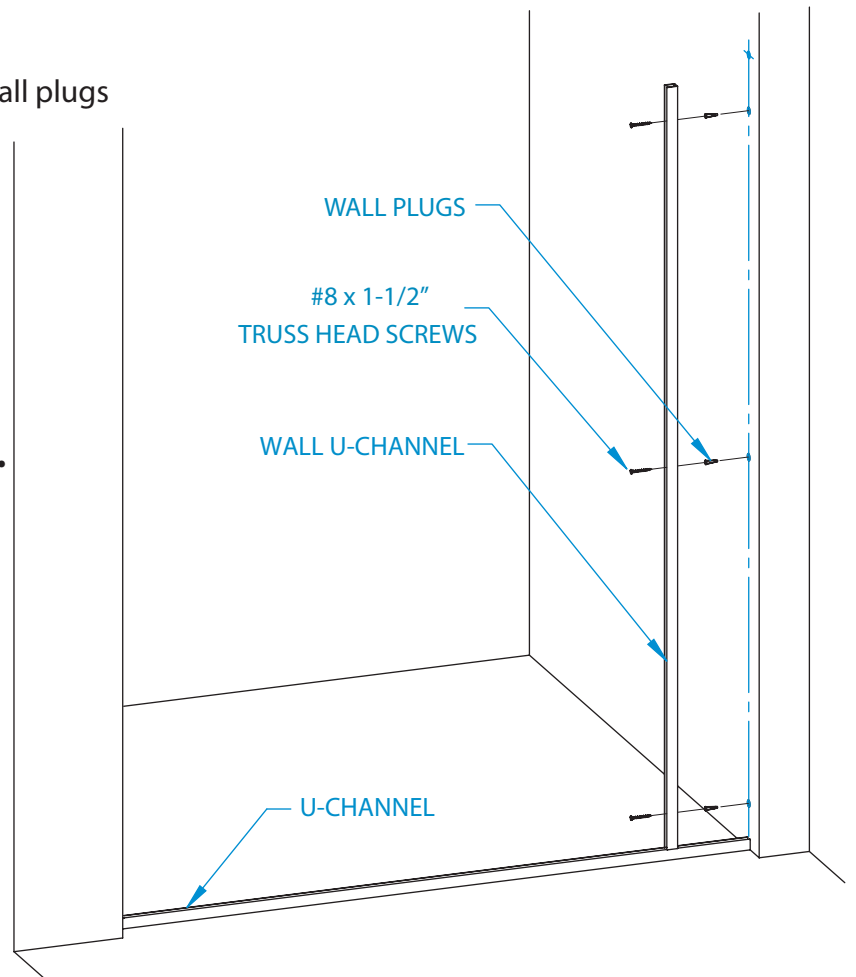

7 Disassemble two Wall Mount Header Brackets [7] by loosening the set screws. Next, put the supplied large wall plugs into the holes that were drilled in the walls in step 2. Screw the inner part of the Header Bracket [7] into the wall with the supplied socket countersunk head screw.

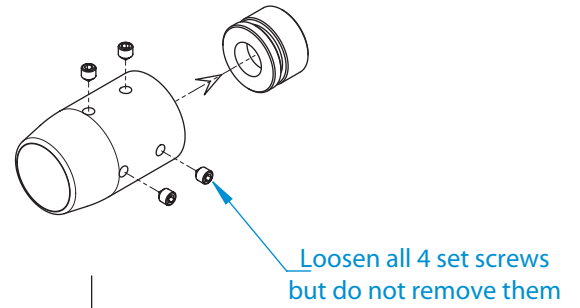
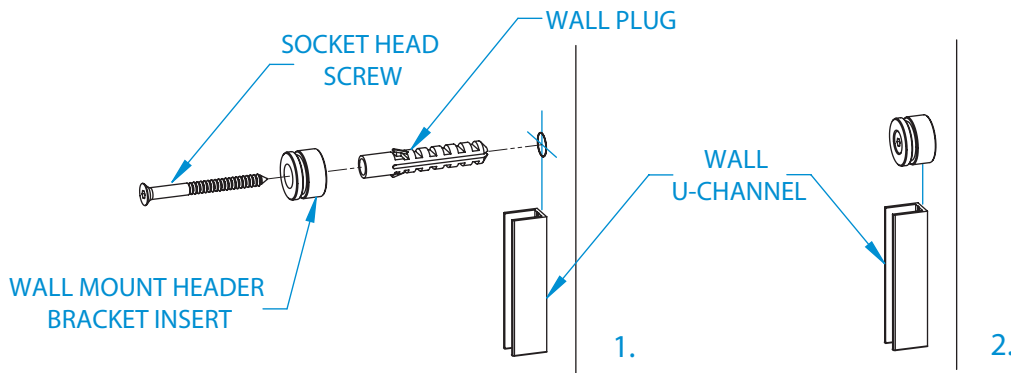

8 Check the size of the Header [1]. It should be equal to the opening size minus 1 1/2" (+/- 1/8" tolerance). Slide the Wall Mount Header Brackets [7] on both ends of the Header [1], align the Header with the inner part of the Header Brackets [7] mounted to the walls and slide out the Wall Mount Header Brackets [7] (see pictures). Rotate the Wall Mount Header Brackets, the set screws should be facing up and inside the shower. Then tighten the 4 set screws on each Wall Mount Header Bracket.

Note: The set screws closest to the wall must be tightened first.

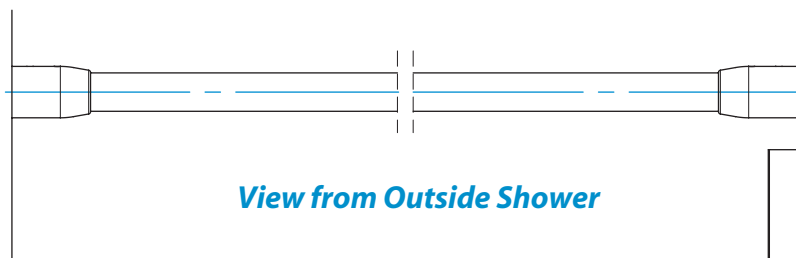
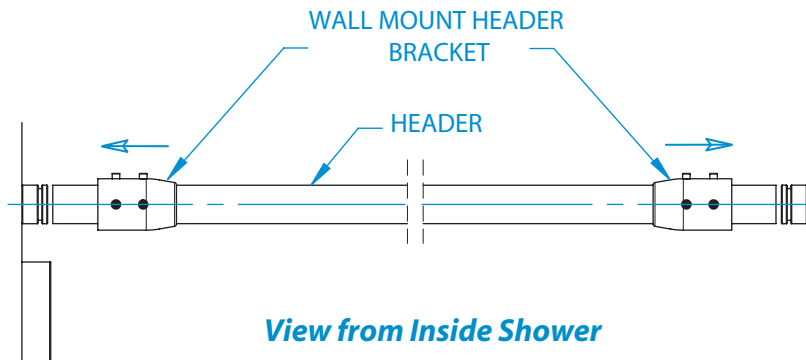
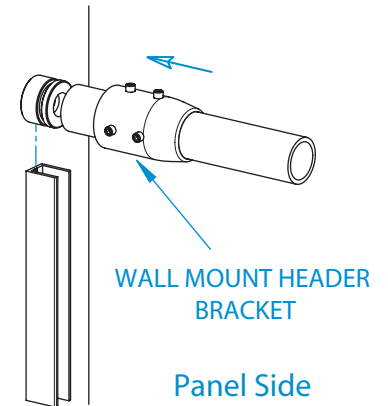

9 Place 1/8" setting blocks [20] into the U-channel as shown or approximately every 18". **DO NOT** place setting blocks over screw heads, but set them close to ensure that the screw heads are below the setting blocks.

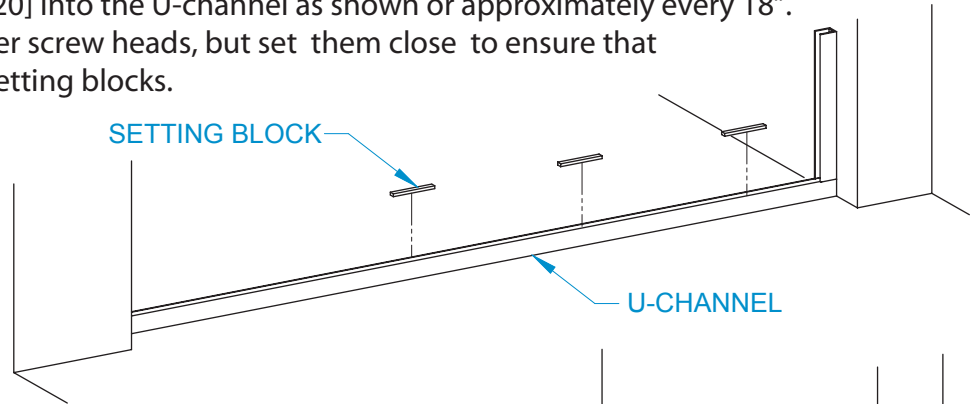

Using suction cups set, the Stationary Glass Panel into the U-channels on the appropriate side. Use different sizes of setting blocks to make exposed edges of the glass level and plumb.** Exposed edges **MUST** be level and plumb before moving to next step.

**Different sizes setting blocks may be required depending on level conditions. Various sizes of setting blocks are provided and can be used in different combinations (stacked) to obtain the desired result.

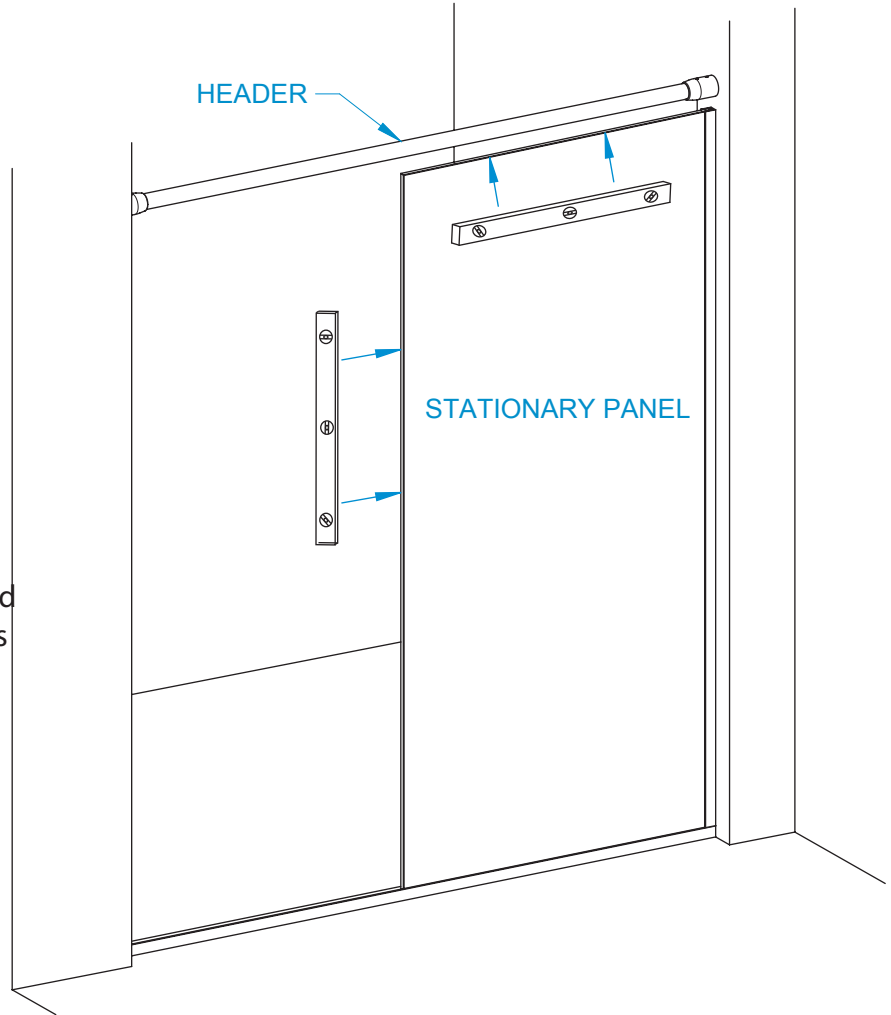

10 Remove the Anti-jumper from the Clamp [8]. Loosen the Clamp screw but do not remove it.

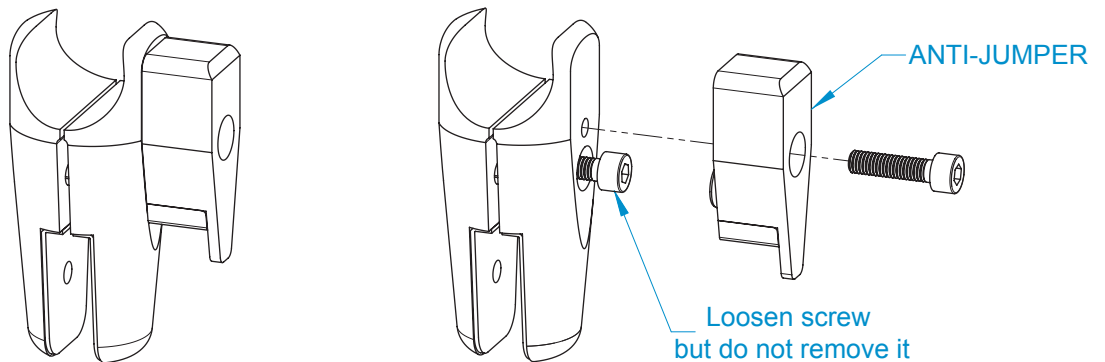

Slide the Clamp [8] over the glass panel and the Header [1] with the screw on the inside of the shower. Set a distance between the exposed glass edge and the Clamp [8] equal to 1/4" then tighten the screw.

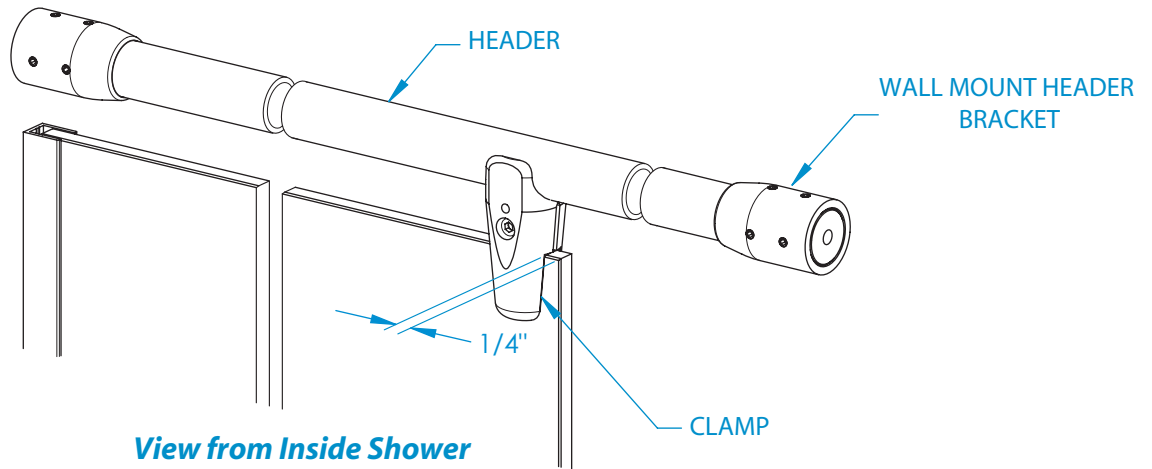

View from Inside Shower

11 Measure the width of the Door Panel. Place a mark on the threshold measuring the same distance from the open wall (See illustration). Place the Guide [11] on the door side of the mark and against inside face of the U-channel. Mark the location of the two mounting holes of the Guide onto the threshold. Next, drill two 3/16" diameter holes at the marked locations. Insert a small amount of silicone into each drilled hole and insert a wall plug into each hole. Then, carefully cut heads off of the wall plugs with a razor blade so there is nothing raised above the surface of the threshold. Place Guide [11] in correct position and secure it with #8 x 1-1/2" truss head screws [18].

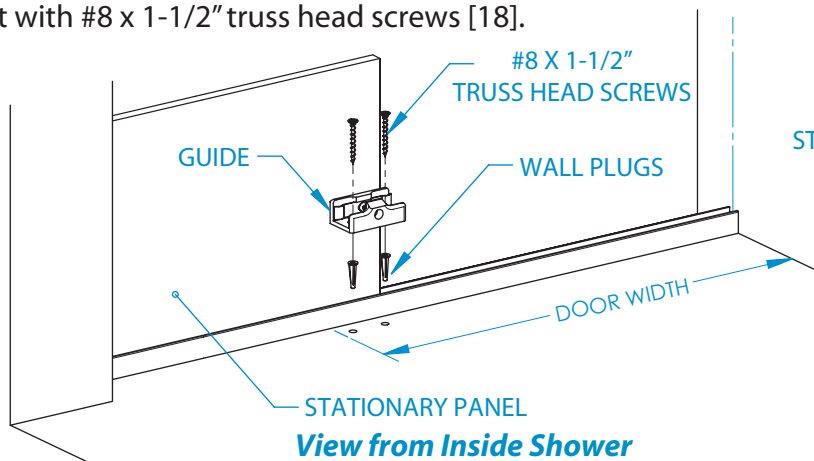

View from Inside Shower

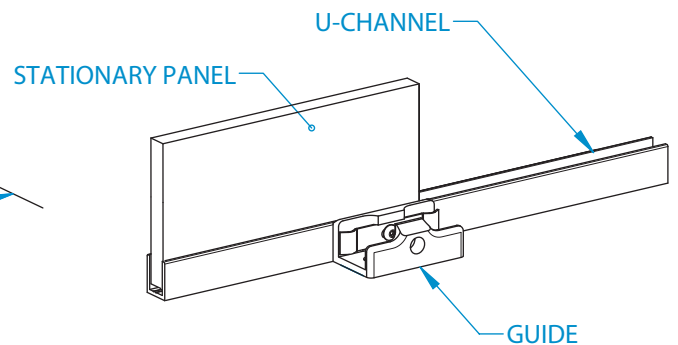

View from Inside Shower

12 Take the Roller with Stopper Pin [9] and set the roller cam shaft by loosening a set screw with the 4mm Allen wrench and rotate the cam shaft to set the adjustment hole to horizontal then retighten the set screw. Do the same steps with the Roller [10]. Remove mount bolts and washers before mounting the Roller Assemblies [9/10] to the Door Panel.

Note: The Rollers [9/10] have +/-1/8" height adjustment.

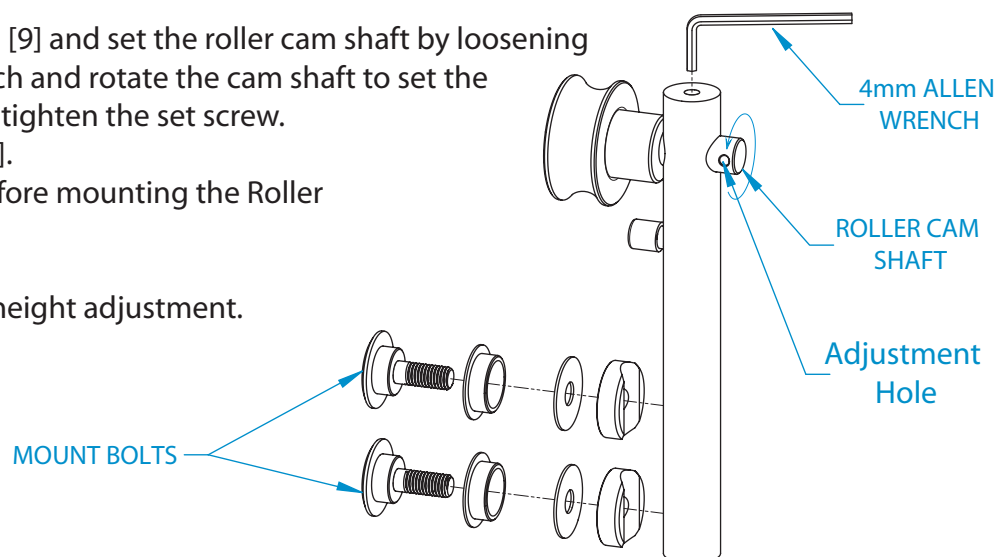

13 Mount the Roller Assembly With Stopper Pin [9] to the wall side of the Door Panel with the bolts facing to the outside of the shower. Mount the Roller Assembly [10] to the stationary panel side of the Door Panel with the bolts facing to the outside of the shower.

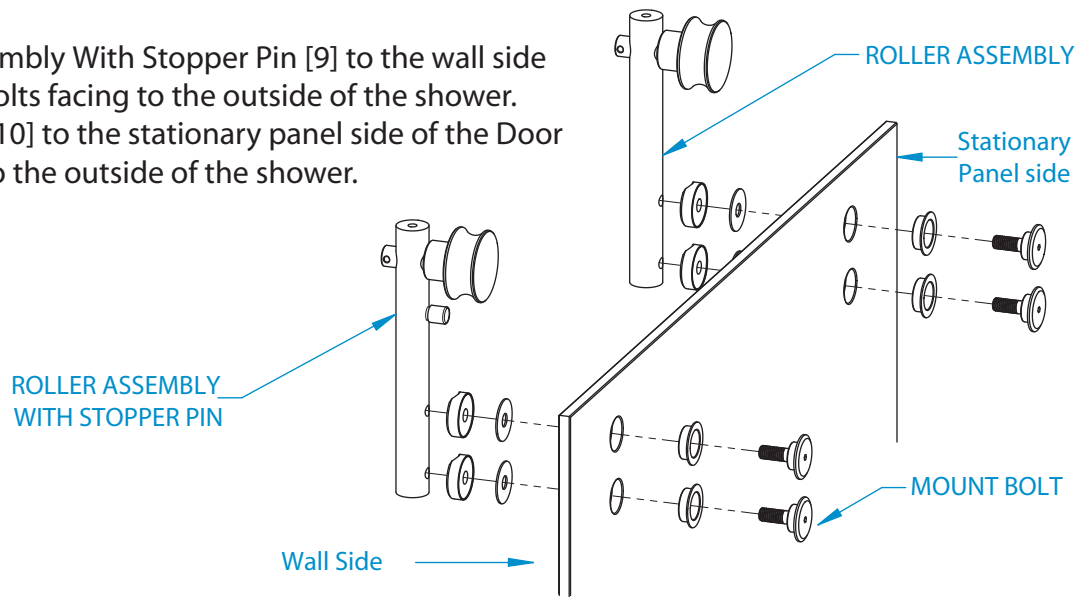

14 Cut the Drip Vinyl [5] to the appropriate size. It should be equal to the Door Width minus 1". Place the Drip Vinyl [5] onto the bottom of the door panel. Line it up on the wall side of the door.

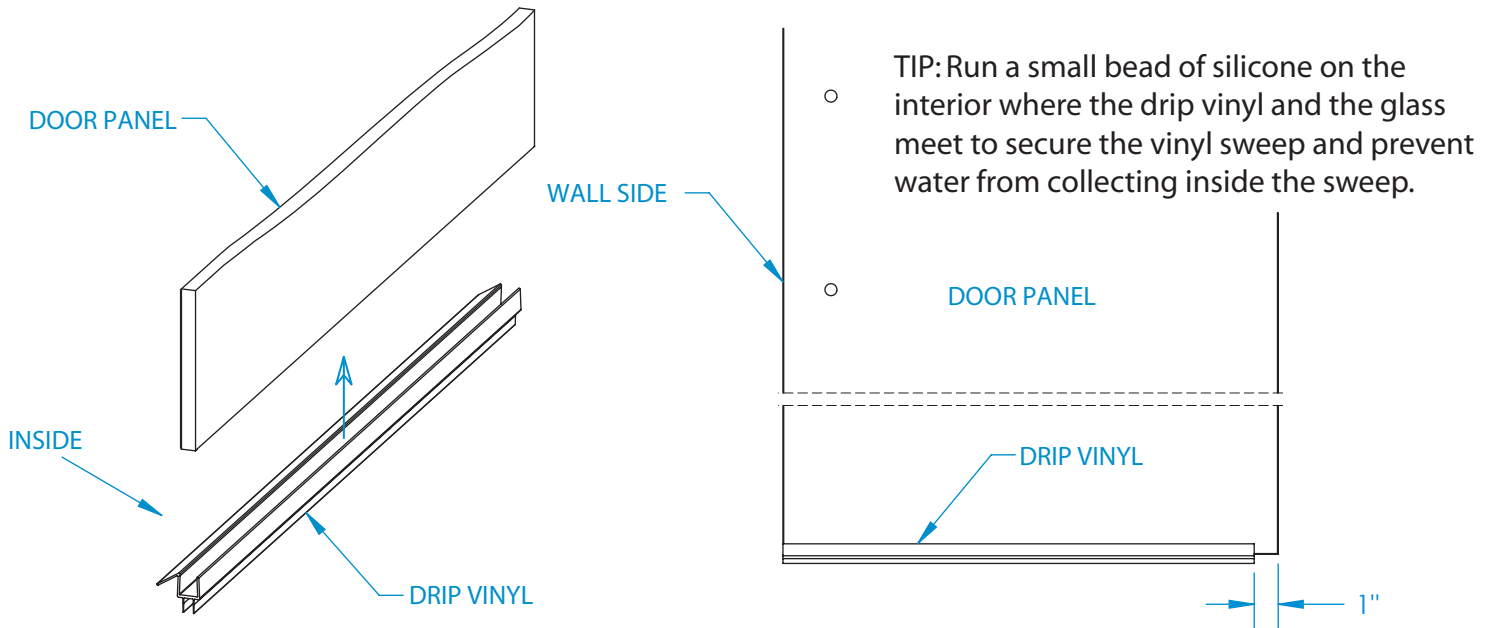

15 Carefully hang the Door Panel with Rollers [9/10] on the Header [1]. Make sure the Door Panel is lined up inside the Guide [11]. Then, if necessary adjust the Door Panel so the top of the glass is flush with the Stationary Panel by loosening the set screw located on the top of the Roller Assembly with 4mm Allen wrench and rotating the cam shaft. (See next page for illustration.)

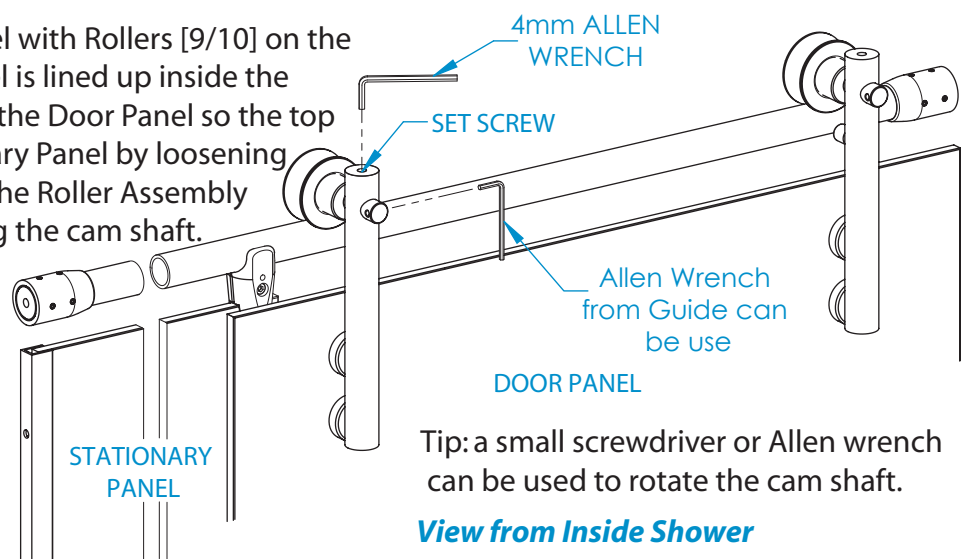
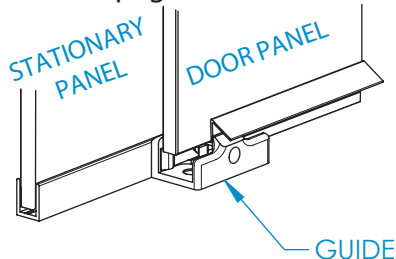

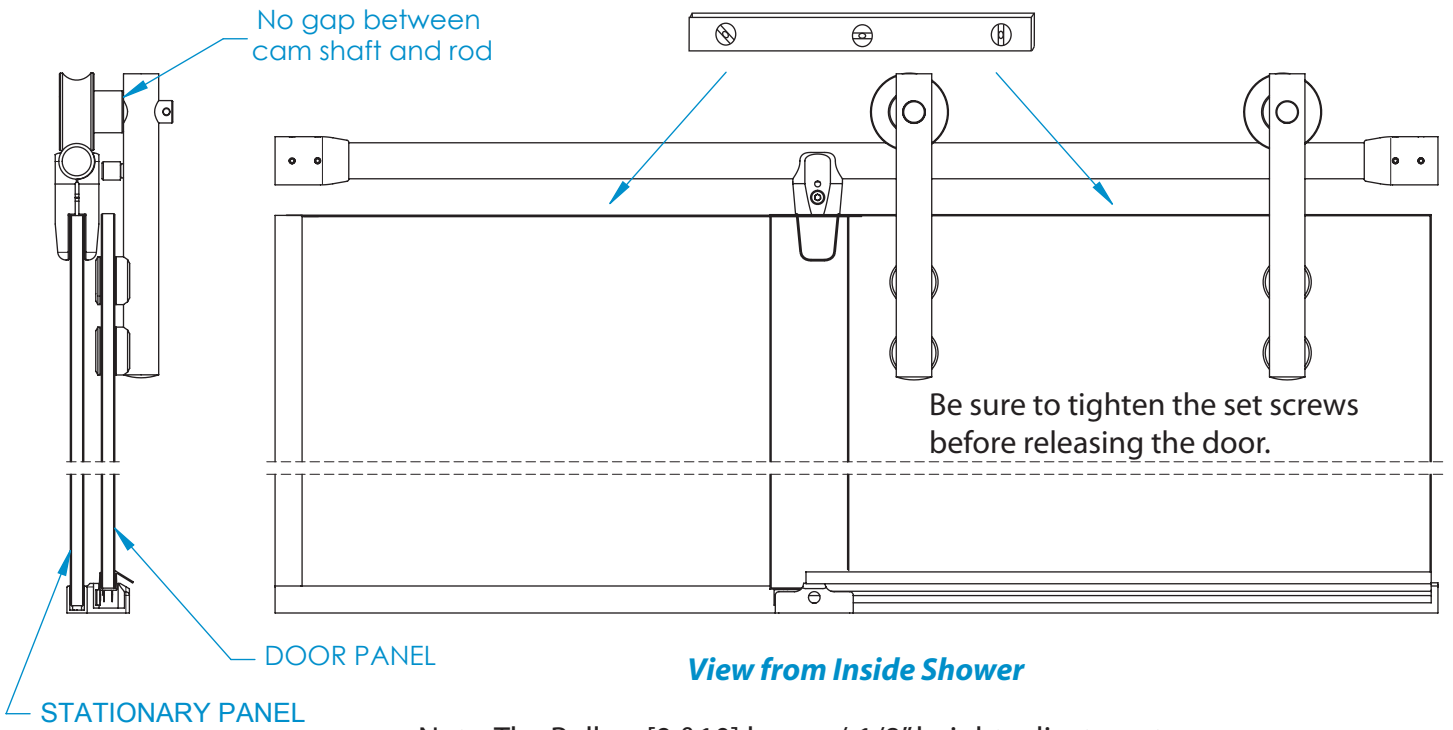

Note: The Rollers [9 & 10] have +/-1/8" height adjustment.

16 Reinstall the Anti-jumper on the Clamp [8] which was removed from the Clamp (see step 10).

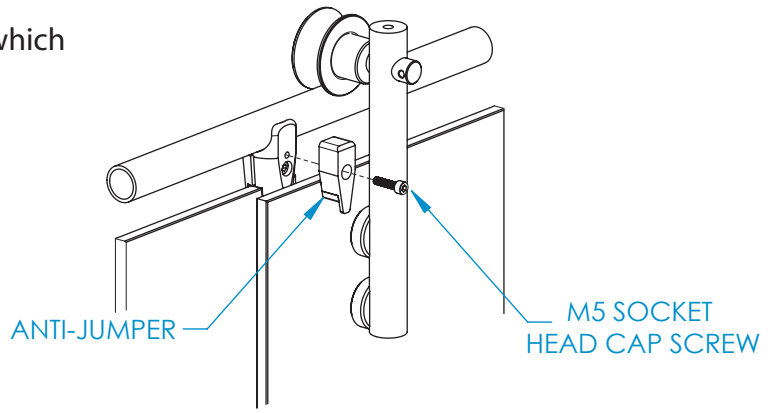

17 You have the option to use the Vinyl Seal [6] or the Bumpers [14/15].

1. For the Vinyl Seal: Cut the Vinyl Seal to size equal to the Door Panel height minus 1/2". Place the Vinyl Seal onto the wall side of the door panel with vinyl lip facing inside the shower.

2. For the Bumpers: Place one bumper to the wall approximately 1/2" from the top of the Door Panel. Place another bumper to the wall approximately 1/2" from the bottom of the Door Panel. (See pictures.) Be sure that the glass will not hit the wall directly. Different sized bumpers are included. Be sure to use the size that allows for the best fit.

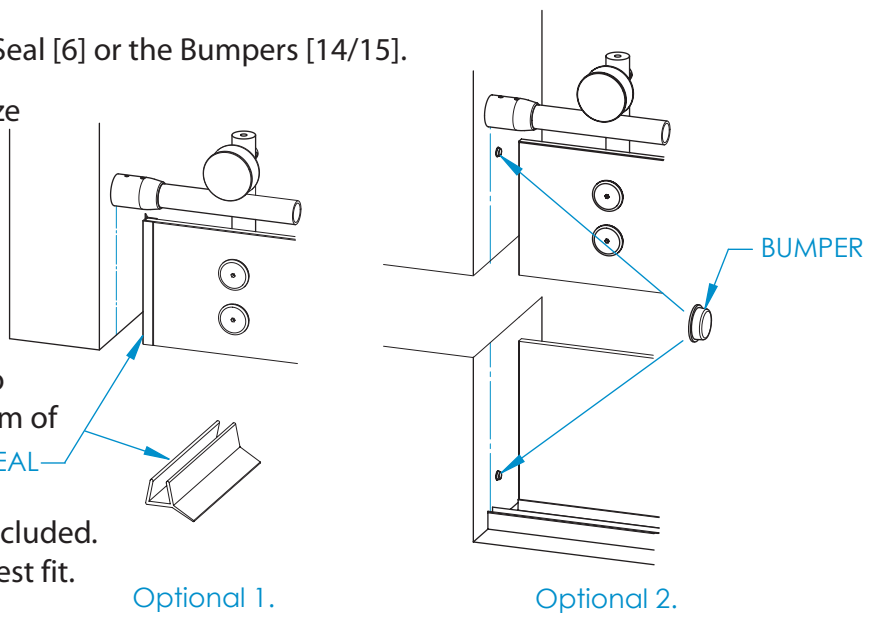

18 Place 18" Pull/Knob [13] or Back to Back Knob [13] on the Door Panel (see pictures).

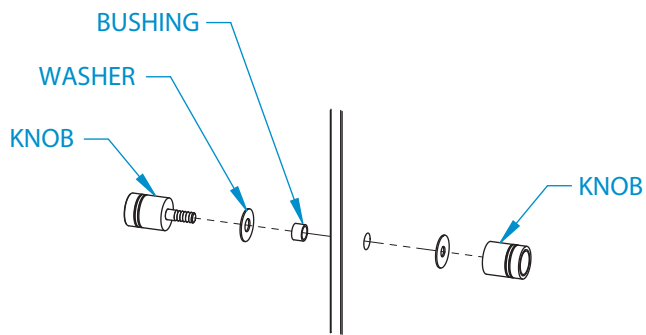

BACK TO BACK KNOB

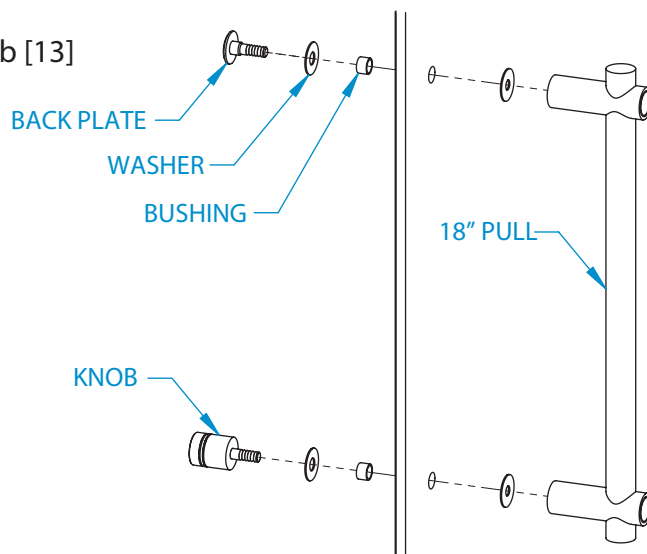

18" PULL/KNOB

19 Place the Bottom Catch [12] onto the bottom of the Door Panel approximately 1/4" from the edge of the door. Completely close the door and adjust location of the Bottom Stopper (see illustrations). Mark its location on the glass (a small piece of tape works best). Remove the Bottom Catch and apply a small amount of silicone to the inner surfaces of the Catch. Place the Catch back onto the glass at its marked location. Run a small bead of silicone where the glass and the Bottom Catch meet on the inside of the Door Panel.

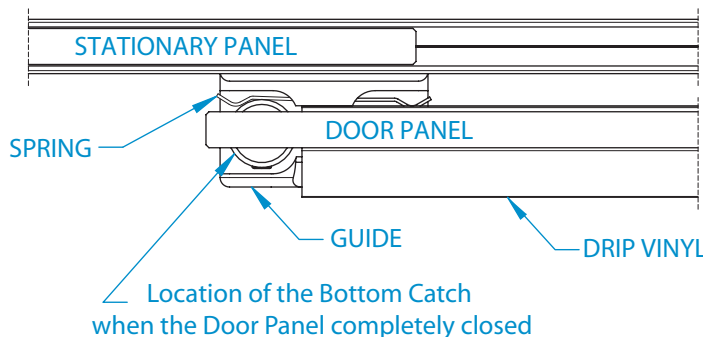
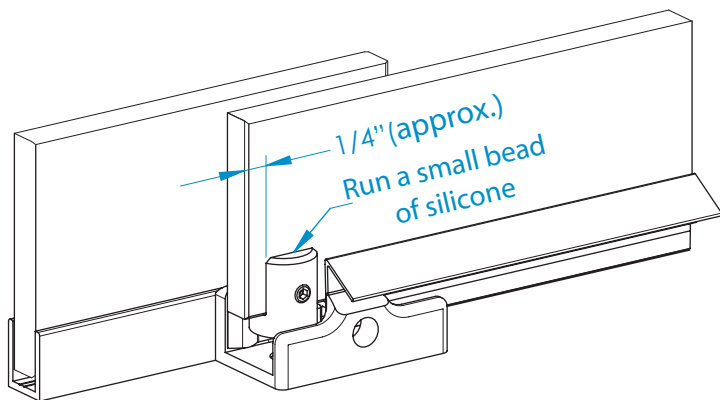

The spring in Guide [11] can also be slightly adjusted using an Allen wrench.

20 Measure the distance between the wall and the Stationary Panel. Then cut the Filler [4] to the measured distance. Run a small bead of silicone along both sides of the Filler [4]. Then insert the Filler into the U-channel [2] (see illustrations).

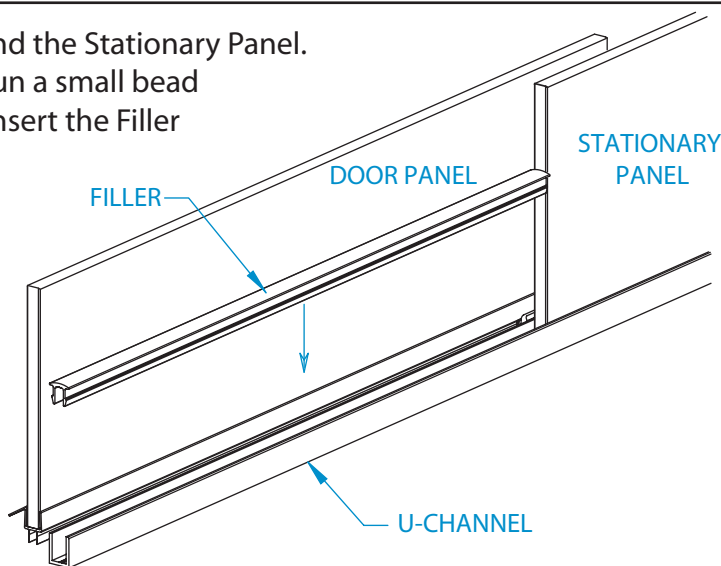
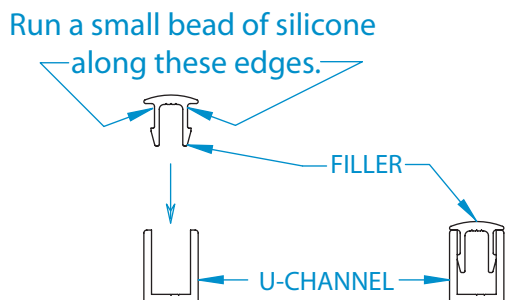

21 On the interior face of the Side Panel, place a strip of low tack tape on the glass about 1/8" to 3/16" away from edge of the u-channel both vertically and horizontally. Run a small bead of silicone along this edge. Finally on the interior, run a bead of silicone between the u-channel and the threshold and also between the u-channel and the wall. After completing, remove the tape before silicone sets.

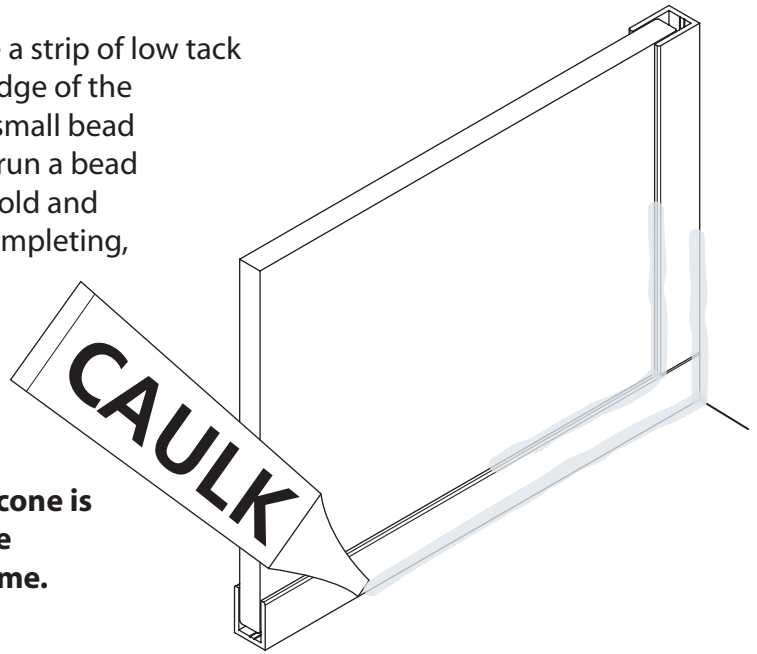

NOTE: DO NOT USE the shower until the silicone is completely cured. Check the tube of silicone for the manufacturer recommended cure time. (typically 24 - 48 hours)

